



Düsseldorf

Host City

PLAYERS INFORMATION

Dear players,

We are pleased to welcome you all to Düsseldorf, at our beautiful venue.

This document "Players Information", aims to provide you with a good understanding of the services scheduled e to make your stay as convenient and comfortable as possible. We hope you enjoy your time in Düsseldorf and wish you all the best for the upcoming competition.

The whole competition is played in the Rochus Tennis Club Düsseldorf [Rochusclub - Google Maps](#).

IMPORTANT CONTACT DETAILS

The below phone numbers will be available from July 29th onwards:

| | | |
|-----------------------------|------------------|-------------------|
| Venue Manager | Selin Seymen | +49 173 53 14 239 |
| Competition Director | Anton Fichtinger | +43 650 3401922 |
| CEV Supervisor | Joep Van Iersel | +31 634 833433 |
| Medical Helpline | Tim Zimmermann | + 49 175 9095037 |
| Transport | Tim Zimmermann | + 49 175 9095037 |

**Only In case of delays in pick up*

Venue - Düsseldorf: [Rolander Weg 15, 40629 Düsseldorf](#)

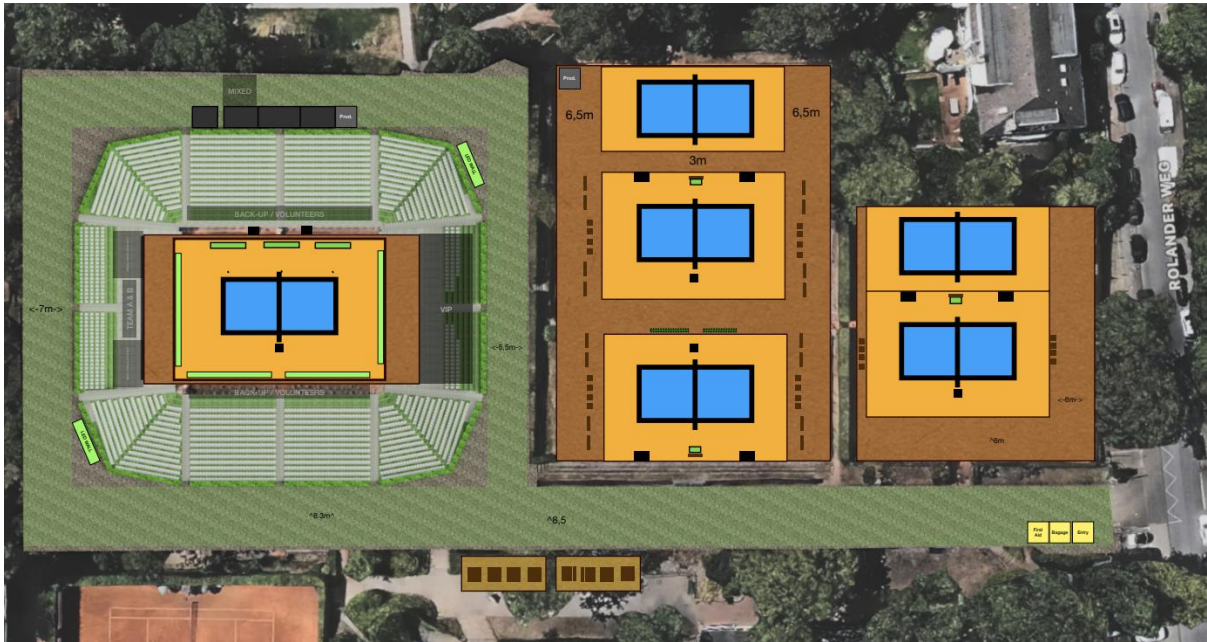

A dedicated flow is planned for your movement within the venue as following :

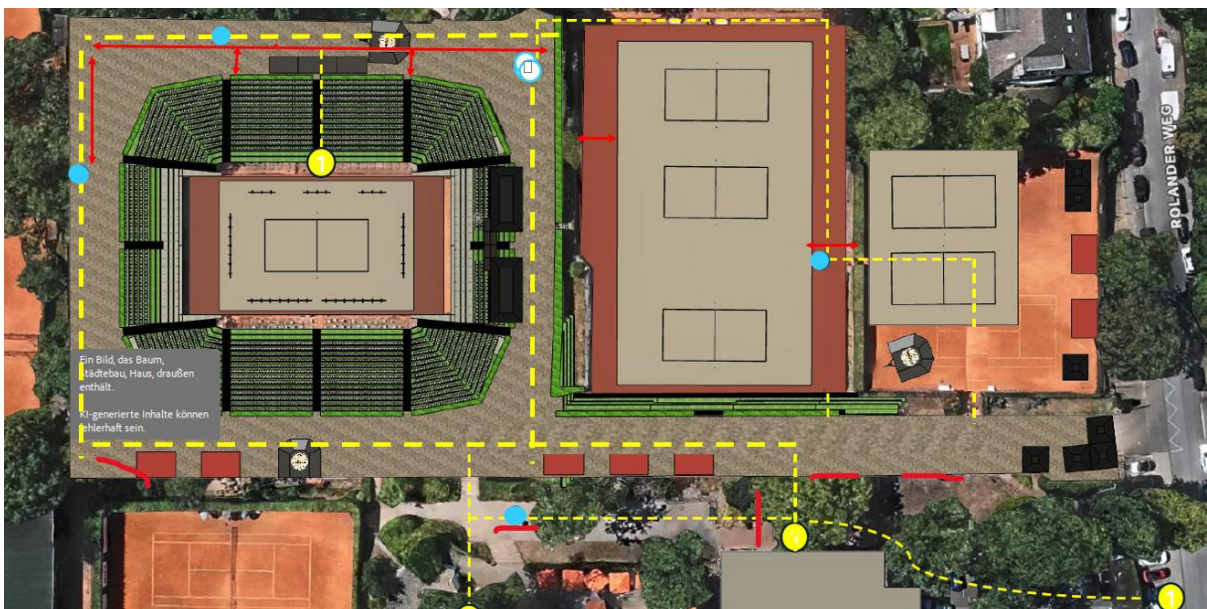

ATHLETES AREAS

A players lounge with direct access to dressing rooms and to the medical areas is developed on the ground floor of the facility.

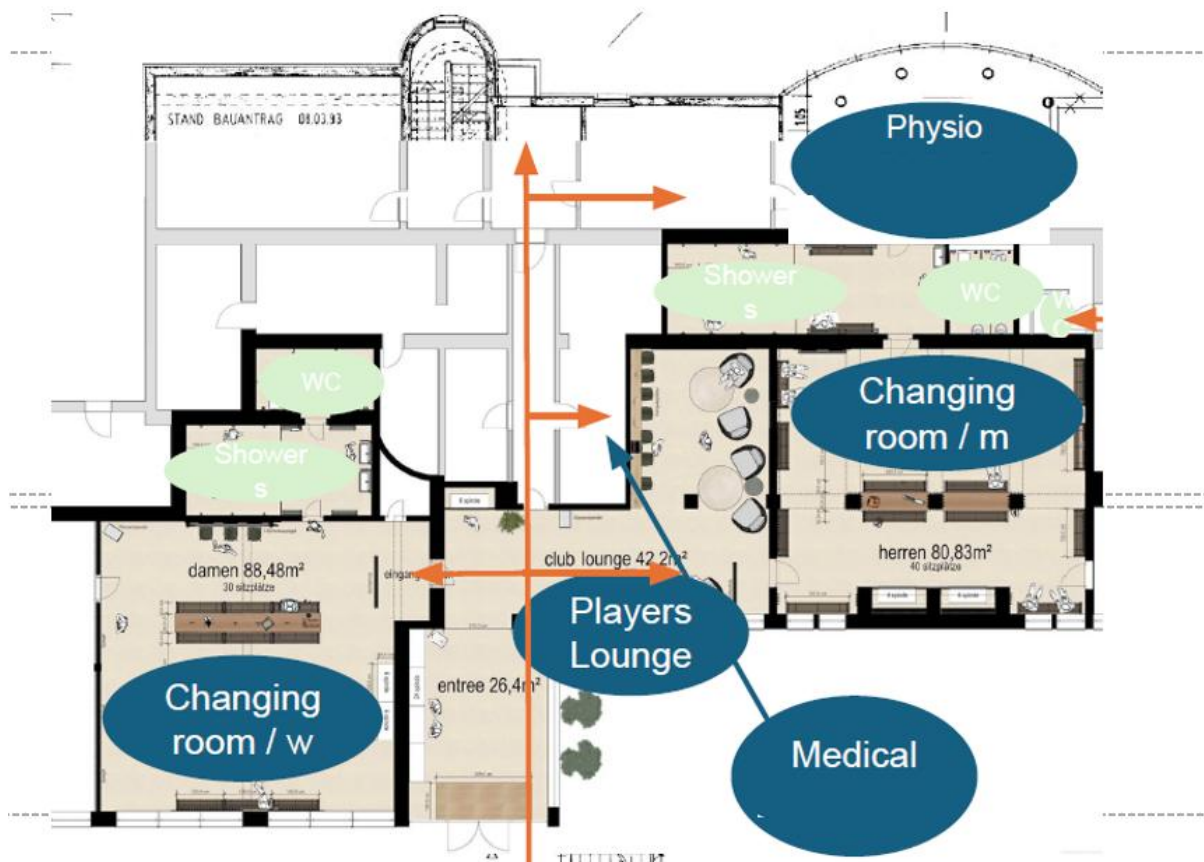

In addition, a small gym is available for the athletes at the venue at the first level of the facility.

You are kindly requested to ensure a proper treatment of all areas within the facility.

ACCOMMODATION

Hilton Düsseldorf Hotel: Georg-Glock-Strasse 20, 40474 Düsseldorf

All players will be provided with accommodation (twin rooms) from the official arrival dates (29.07. 15:00 pm) and until the day after elimination (check-out 12:00 pm) (

Every person is responsible for any and all additional services / extra expenses at the hotel such as mini-bar, phone calls, laundry and/or any damages.

Hotel rooms for official delegation members are not included and should be booked according to the provisions of the events Practical Info.

Please make sure you are as sand free as possible before entering the hotel.

PRELIMINARY INQUIRIES

Preliminary Inquiries for Women: from **16:30 to 17:30** at the Hotel (Room Aristoteles on Ground floor)

Preliminary Inquiries for Men: from **17:45 to 18:45** at the Hotel Room Aristoteles on Ground floor)

Please note: You have to attend the Preliminary Inquiry to sign in for the tournament!

All athletes need to bring their bikini bottoms / shorts and sporting gear for a photo shooting. The LOC will provide the necessary changing room/space.

ACCREDITATION

Players and Official delegation members can pick up their accreditation Upon check in to the hotel on Tuesday July 29th.

Any last minute accreditation requests, should be addressed to the malin.bruns@nbo.cool mail account and are subject to confirmation.

Please note that requests for all delegation members need to be supported with the photo of the applicant and relative accreditation documents as detailed in the Event Practical Info.

Please ensure that your accreditation is always with you and visible to ensure access to designated areas and to prevent misunderstandings.

If you have any further questions, please do not hesitate to contact Accreditation Manager **Malin Bruns** at malin.bruns@nbo.cool .

FITNESS CENTRE

A workout room is available at the Hilton Hotel and at the Venue Rochusclub

MEALS

Breakfast:

At the hotel: Weekdays from 6:30am - 10:30am / Weekend: 6:30am - 11:00am

Lunch:

At the Venue from 12:00 pm - 15:00 pm

Dinner:

At the hotel from 18:30 pm - 21:45 pm

Lunch and dinner are provided to all players through meal vouchers that will be handed out during Preliminary Inquiry for the Pool Phase and through the Competition Management Office for the Single elimination Phase.

No meals will be served without these vouchers.

TRAINING SESSIONS

Training will start on Monday 28.07.2025 at 9:00 am. You can book your first training here below. You can book every other session one day earlier as per the guidelines available here [trainings-booking-handbook-players-eurobeach.pdf](#). Slots are 30 minutes per team.

The Booking Site is: [Reservation Eurobeach Düsseldorf | Beachvolleyball Trainings Courts Reservation](#)

Please ensure that there is no conflict with your Preliminary Inquiry (Be aware of transportation times, etc.).

TRANSPORTATION

Arrival

Teams arriving at Düsseldorf Airport or Train Station that have provided their BV-04 form before July 21st as per the provisions of the Practical Info and arrive on the official arrival days, will receive a shuttle transfer or a Voucher from Düsseldorf Airport to the hotel.

Departure

For your departure shuttle to the airport please contact the Competition Management Office, the day before your departure and declare the departure time from the hotel, your flight number and your destination.

Shuttle services:

During the competition a shuttle service operates between the player's hotel and the event venue on a regular basis as following:

Monday and Tuesday

08:30 from the hotel to the venue and every hour – last shuttle at 18:30

10:00 from the venue to the hotel and every hour up to 18:00– last shuttle at 19:15

Wednesday, Thursday & Friday

08:30 from the hotel to the venue and every 30 min– last shuttle at 18:30

11:00 from the venue to the hotel and every every 30 minutes up to 19:00– last shuttle at 20:15

Saturday

10:00 from the hotel to the venue and every 45min– last shuttle at 18:15

11:30 from the venue to the hotel and every 45min up to 18:30 – last shuttle at 20:15

Sunday

09:00 from the hotel to the venue and every 45min – last shuttle at 18:00

12:30 from the venue to the hotel and every 45min to 18:30– last shuttle at 20:30

Travel times:

- Hotel - Event Venue: 20+ min
- Event Venue - Hotel: 20+ min
- Hotel - Airport: 10+ min
- Hotel – Train Station: 15+ min

PLAYERS UNIFORMS

Each team will receive 1 set of (tank-) tops before each match at the competition court from the referees.

Please keep the (tank-)tops throughout the tournament.

VIDEO SHARING

Videos of the matches will be available to download on the following Cloud: <https://spontent.cloud/> through a registration process detailed in the event Practical Info.

This link takes you to a folder that has the competition days in each of them with the respective matches.

MEDICAL

Medical assistance will be available from the 1st day of competition and is located next to the Players Lounge (see players area layout on Page 3).

Treatments will be available 30 minutes before the start of the first match until 30 minutes after the end of the last match.

One physiotherapist will be available to assist during the official training sessions, from Monday 28/07 onwards.

FAMILY & FRIENDS TICKETS

Each team playing a match on a match day is eligible for up to four Family & Friends Tickets per day. This also applies to teams playing their matches on the side courts. Reserved seats will be available on center court. Separate areas will be provided on the side courts.

To get these Tickets please fill out the form here [CEV EuroBeachVolley 2025 - Friends & Family of players](#).